

Shipping Info:
2 boxes 24x22x18 (5.5 ft ea
Total Weight: 105 lbs

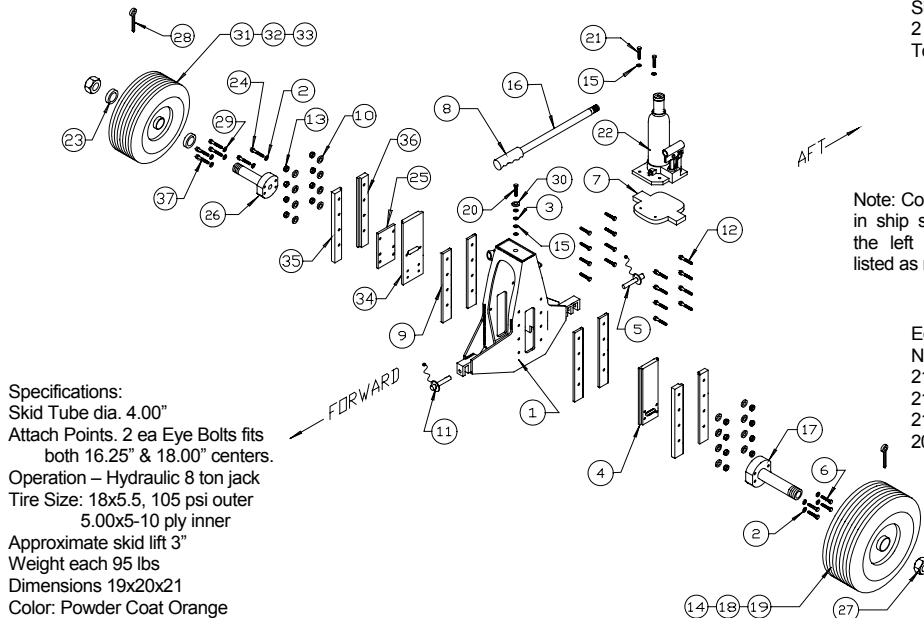

Specifications:
Skid Tube dia. 4.00"
Attach Points: 2 ea Eye Bolts fits
both 16.25" & 18.00" centers.
Operation - Hydraulic 8 ton jack
Tire Size: 18x5.5, 105 psi outer
5.00x5-10 ply inner
Approximate skid lift 3"
Weight each 95 lbs
Dimensions 19x20x21
Color: Powder Coat Orange

Note: Complete assemblies are sold
in ship sets which consists of both
the left and right side. Parts are
listed as number required per side.

Equivalent:
NSN 1730-01-133-9204
214-706-104-101/105
214-706-104-003 (old style)
214-050-200-105/107
204-050-200-005/101

Page 1 of 1

HI-GROSS:

BELL 204, 205, 206L, 212, 222UT, 412, UH1, AH1, AH1W

MODEL: **BDW-245C-1800/500**

ITEM NO.	PART NUMBER	DESCRIPTION	NO REQ
1	W-245AC-00 & 01	WELDED FRAME ASSEMBLY	1
2	WASHER LOCK 3/8	LOCK WASHER	6
3	1/4x3/8x3/8	BUSHING	1
4	W-245B-04	AXLE SLIDE	1
5	CL8BLPL3.00C	BALL LOCK PIN - W/ LANYARD	1
6	BOLT 3/8-24 X 1 1/4	BOLT	4
7	W-245B-09	JACK BASE	1
8	HG-1	HANDLE GRIP	1
9	W-245B-08	WEAR PLATE	4
10	WASHER SAE 5/16	WASHER	24
11	CL8BLPB2.00C	BALL LOCK PIN 2"	1
12	BOLT 5/16-18 X 1 1/4	BOLT	24
13	NUT LOCK 5/16-18	LOCK NUT	24
14	W-18 X 5.5 TR	8 PLY TIRE	1
15	WASHER HCLW 1/4	HIGH COLLAR LOCK WASHER	6
16	W-245-14-00	JACK HANDLE ASSEMBLY w/ GRIP	1
17	W-245B-11	SPINDLE	1
18	W-5.30-8 TB	NON AIRCRAFT USE TUBE	1
19	40-117A	WHEEL	1
20	BOLT 1/4-20 X 1	BOLT	1
21	BOLT ALLEN 1/4-20 X 3/4	ALLEN BOLT	2
22	W-245-22C	8 TON NORCO JACK	1
23	W-245-19	SPINDLE WASHER	2
24	BOLT 3/8-24 X 3/4	BOLT	2
25	W-245B-21A	500 REINFORCEMENT PLATE	1
26	W-245-17A	500 X 5 SPINDLE	1
27	W-245-25	CASTLE NUT	2
28	PIN COTTER 1/8 X 2 1/2	COTTER PIN	2
29	WASHER LOCK 5/16	LOCK WASHER	4
30	WASHER USS 1/4	WASHER	2
31	40-77	5.00 X 5 WHEEL	1
32	W-5.00 X 5 TR	TIRE 10 PLY	1
33	W-5.00 X 5 TB	TUBE	1
34	W-245B-04B	AXLE SLIDE	1
35	W-245B-05L	LEFT GUIDE	2
36	W-245B-05R	RIGHT GUIDE	2
37	BOLT 5/16-18 X 1 1/2	BOLT	4
NS	608500N SEAL KIT	REPAIR KIT FOR 8 TON NORCO	1