

BRACKETT AIRCRAFT COMPANY INC.

www.brackettaircraft.com

HT-10M

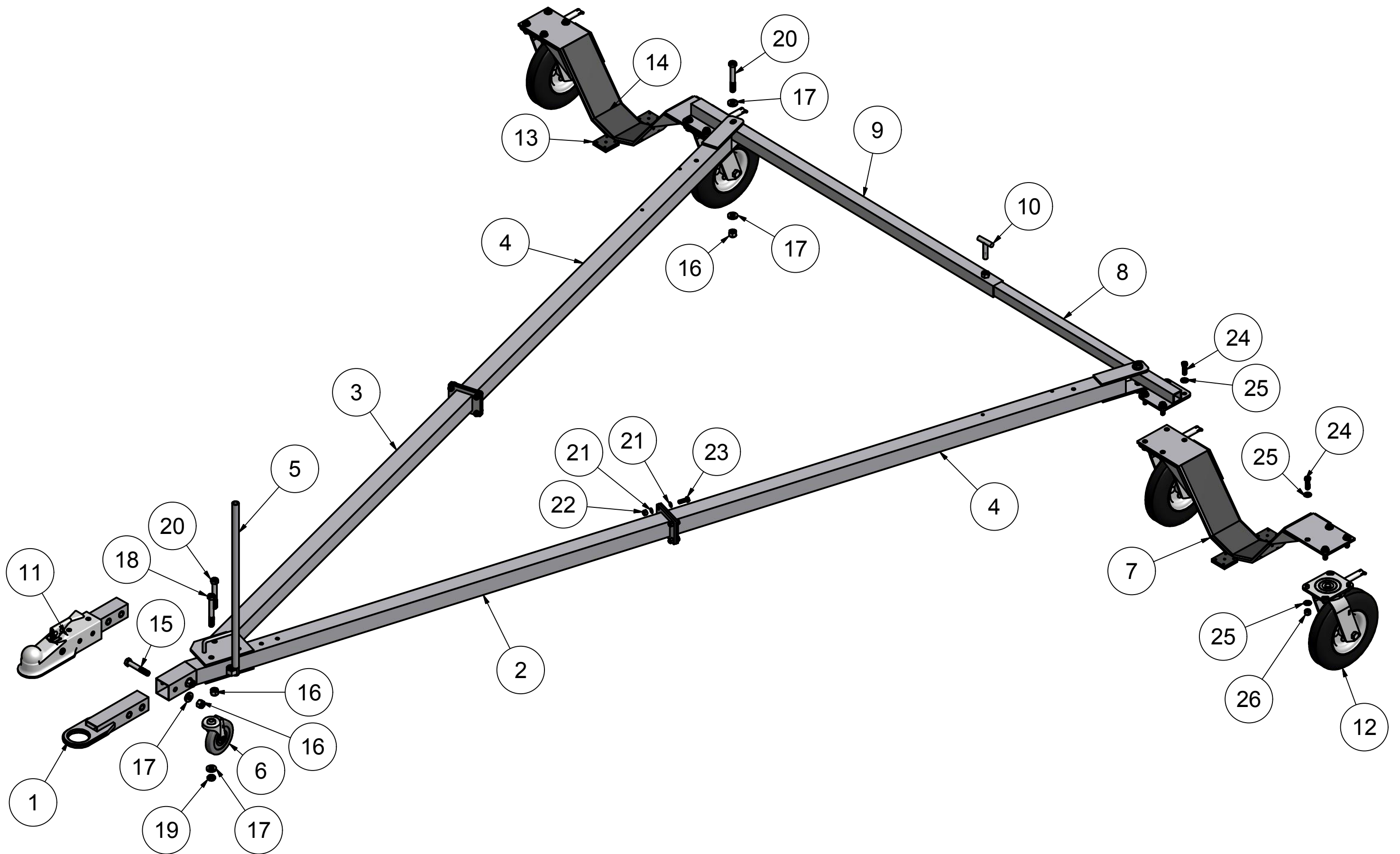

PARTS LIST

ITEM	QTY	PART NUMBER	DESCRIPTION
1	1	T-12-600R	RING HITCH
2	1	H-7M8-10	YOKE ASM.
3	1	H-7M2-10	LEG ASM.
4	2	H-7M9-10	LEG ASM.
5	1	TY-TB-125-10-00	HANDLE
6	1	HM-101	CASTER WHEEL
7	2	H-10M-01-00	SADDLE
8	1	H-10M-03-00	INNER SLIDER
9	1	H-10M-02-00	OUTER SLIDER
10	1	HT88-10-00	T HANDLE
11	1	T-12-600B	BALL HITCH
12	4	16SF-08-527-S-L	PNEUMATIC CASTER WHEEL
13	4	10M ROUGH BACK 2	TAB
14	2	ROUGH BACK	ROUGH BACK
15	2	91286A337	1/2-13 X 3 BOLT
16	5	90630A125	1/2-13 LOCKNUT
17	9	98180A150	1/2 WASHER
18	1	91286A342	BOLT 1/2-13 X 3 3/4
19	1	94945A224	1/2-13 NYLON-INSERT THIN LOCKNUT
20	3	91286A339	1/2-13 X 3 1/2 BOLT
21	16	AN960-516L	5/16 NARROW WASHER
22	8	90630A115	5/16-18 LOCKNUT
23	8	91286A155	BOLT 5/16-18 X 1
24	16	91286A201	3/8-16 X 1 1/4 BOLT
25	32	98180A130	3/8 WASHER
26	16	90630A121	LOCKNUT 3/8-16