

# BRACKETT AIRCRAFT COMPANY INC.

www.brackettaircraft.com

## RL-EF TOW BAR FOR EDO FLOATS

USE ON: EDO FLOATS MODEL 2790, 3500  
 GTOW: 5,000 LBS.  
 LENGTH: 120"  
 COLOR: POWDER COAT ORANGE  
 SHIPPING: 9" X 9" X 73" @ 39 LBS.

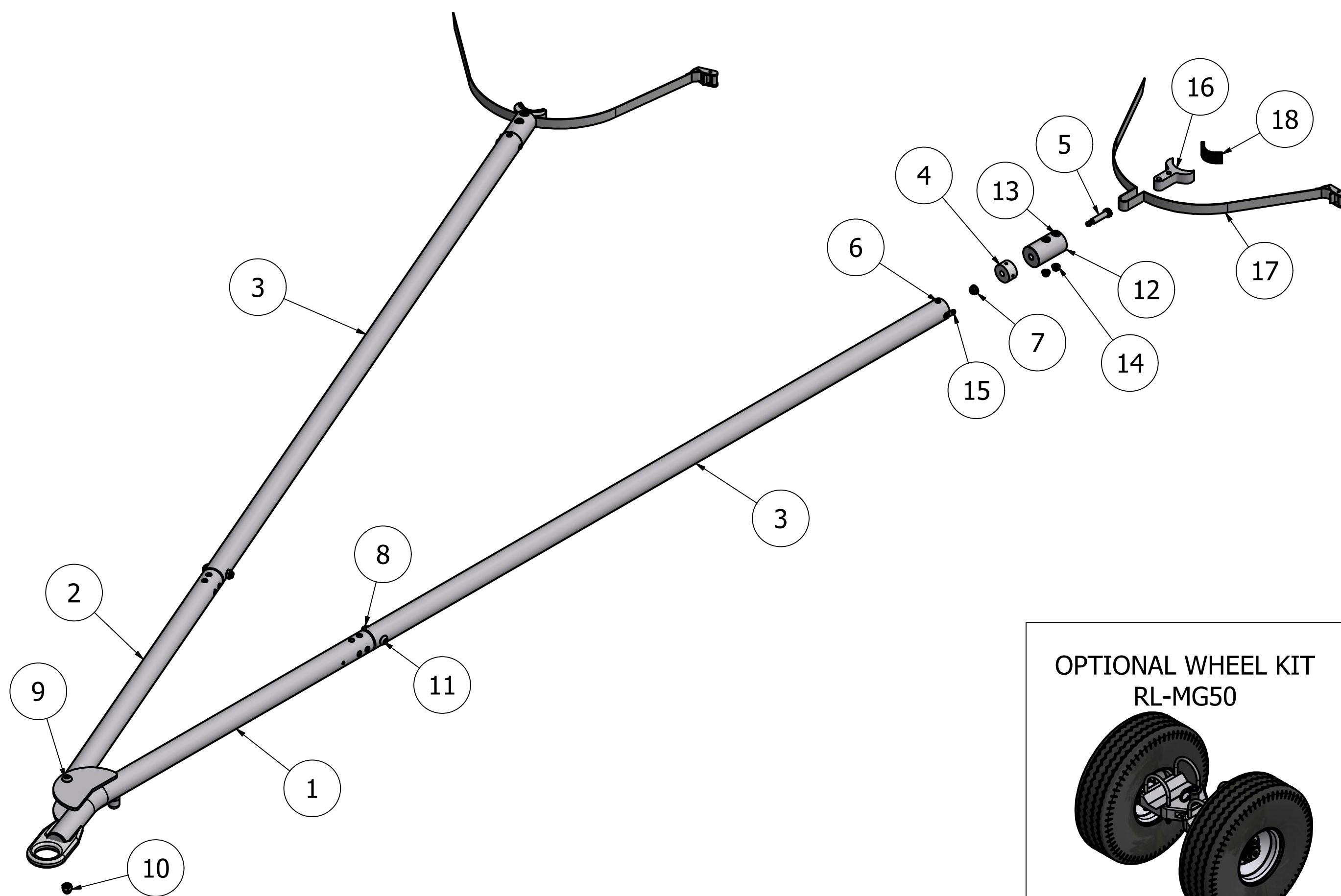

### PARTS LIST

| ITEM | QTY | PART NUMBER    | DESCRIPTION                        |
|------|-----|----------------|------------------------------------|
| 1    | 1   | HT429-01-00R-4 | YOKE ASM.                          |
| 2    | 1   | HT429-02-00-4  | UPPER LEG                          |
| 3    | 2   | RL-MG06        | LOWER LEG                          |
| 4    | 2   | TR-74-07       | GUIDE                              |
| 5    | 2   | 97345A718      | 1/2 X 1 3/4 X 3/8-16 SHOULDER BOLT |
| 6    | 8   | 92949A537      | 1/4-20 X 1/2 BHCS                  |
| 7    | 2   | 92018A430      | 3/8-16 FLANGE NUT                  |
| 8    | 2   | 94945A224      | 1/2-13 NYLON-INSERT THIN LOCKNUT   |
| 9    | 1   | 92949A880      | 1/2-13 X 3 1/4 BHCS S.S.           |
| 10   | 1   | 90507A033      | 1/2-13 SELF LOCKING ACORN NUT      |
| 11   | 2   | 92949A722      | 1/2-13 X 2 1/2 BHCS S.S.           |
| 12   | 2   | RL-EF-05       | SADDLE BASE                        |
| 13   | 4   | 92949A591      | 5/16-18 X 2 BHCS S.S.              |
| 14   | 4   | 92018A320      | 5/16-18 FLANGE NUT                 |
| 15   | 2   | 90312A250      | 8" LANYARD                         |
| 16   | 2   | RL-EF-01B      | STRUT SADDLE                       |
| 17   | 2   | 45052S         | CINCH STRAP                        |
| 18   | 2   | RL-EF-02       | ROUGH BACK                         |
| OPT. | 1   | RL-MG50        | OPTIONAL WHEEL KIT                 |